



# Installation Guide

ACMG10



Thank you and congratulations on purchasing your Concierge ACMG10 product. Your package should contain the following:

- ACMG10 - 10" Room Booking Panel,
- Plug Pack Power Supply,
- T-Bar Table Stand,
- Connector Locking Bracket, and
- Concierge Details Card.

## Hardware features



## Securing the network and power connections

1. Insert the Network connector only if Power over Ethernet (PoE) is available. Insert both Network and Power connections when PoE is not available.
2. Secure the connectors with the supplied bracket and screw as shown on right.

Figure 9: Installing the cable securing plate

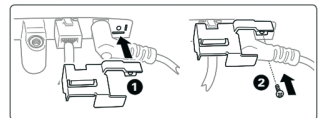

**Please note:** The bracket is designed for network connectors with no cable boot. The bracket will not fit moulded network cables or cables with boots installed.

**Note:** When installed on a wall, the LAN connector locking tab can be difficult to access. Using a small flat bladed screwdriver may help. Removal of the panel may also be required. Please be careful when connecting and disconnecting the network cable. Excessive force can damage the connector.

## Mounting your Concierge ACMG10

Your Concierge ACMG10 panel can be mounted using the Plastic Rear Cover or an aftermarket 75 x 75 VESA mounting bracket. Prepare the location and cable access holes as required for your specific application.

### Rear Cover Mounting Bracket



1. Remove the rear cover screw at the top and place the unit face down on the supplied packaging then gently prise off the cover starting from the top left and right corners working your way down.



2. Secure the back cover to the mounting surface and secure with screws appropriate for the material using the 3 holes shown. Ensure that the height of the screw heads is no more than 3mm.



3. Route the network and or power cables through the cover as shown in the image to the right.



4. Plug and network and power connectors and carefully press the ACMG10 into the rear cover until it clicks. Gently squeeze each corner between your thumb and forefinger until the cover is completely in place. Re-install the screw in the top of the panel.

## VESA Mounting Bracket

Secure the 75 x 75 VESA mounting bracket to the panel using 4 x M4 screws where the thread will be no longer than 4mm into the panel.

After installing your ACMG10, please remove the two plastic films protecting the front of the LCD.

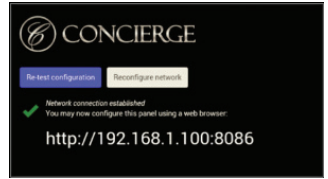

Window Mounting (ACMG10WM) and Flush Wall Mounting (ACMG10FM) options are also available, please consult your Concierge Dealer or visit [www.conciergedisplays.co](http://www.conciergedisplays.co) for information on these mounting options.

## IP network connection and addressing

When your Concierge ACMG10 panel powers up it will try to connect to a network. The unit is configured for DHCP.

After powering up, the panel will show the IP Address details on the splash screen shown below. If the unit does not show an IP address, and for additional configuration instructions please refer to the User Guide available at: <https://conciergedisplays.co/quickstart/>

Concierge recommends network and power connections by Power over Ethernet installation. WiFi is turned off by default. To turn WiFi on, select Basic Setting on the ACMG10 during boot up, default password is admin. Then follow the prompts to active WiFi.

## Recording your installation details

Your Concierge ACMG10 was supplied with a Concierge Details Card. Use this card to record specific information about this panel like location and IP Address. This information is important to anyone configuring and setting up the unit particularly if there are multiple locations.